

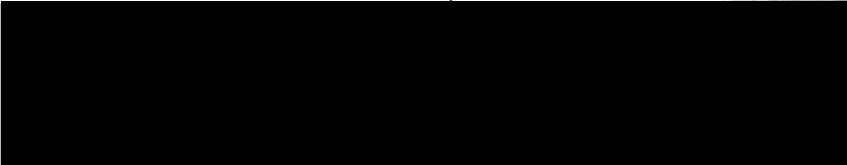

Clare County Development Plan 2023-2029

Submission / Observation Sheet

NAME	ADDRESS	CONTACT DETAILS: EMAIL / PHONE NUMBER
<i>Patrick KEATING</i>		

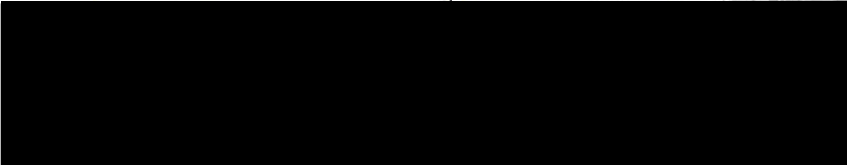

CLARE COUNTY COUNCIL

08 FEB 2022

Regional Planning Section

Clare County Development Plan 2023-2029

Submission / Observation

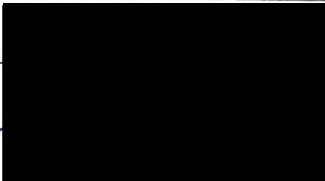

To: WHOM IT CONCERNS:

Re: County Development Plan - 2023 To 2029

I wish to make a submission regarding part of land at Ballybeg, Ennis which is ZONED low density in the present Development Plan.

In the new Development Plan it is proposed to revert back to agricultural land. This proposal makes no sense as this is infill & there is houses all around the area. Therefore, I suggest it should be left low density as it is at present.

I enclose a map of the said area which is marked in red.

Signature: Patrick Keating

Date: 8-1-2022

Rural PLACE Map

Surveyed 2001
Revised 2001
Levelled 0



133523
174947

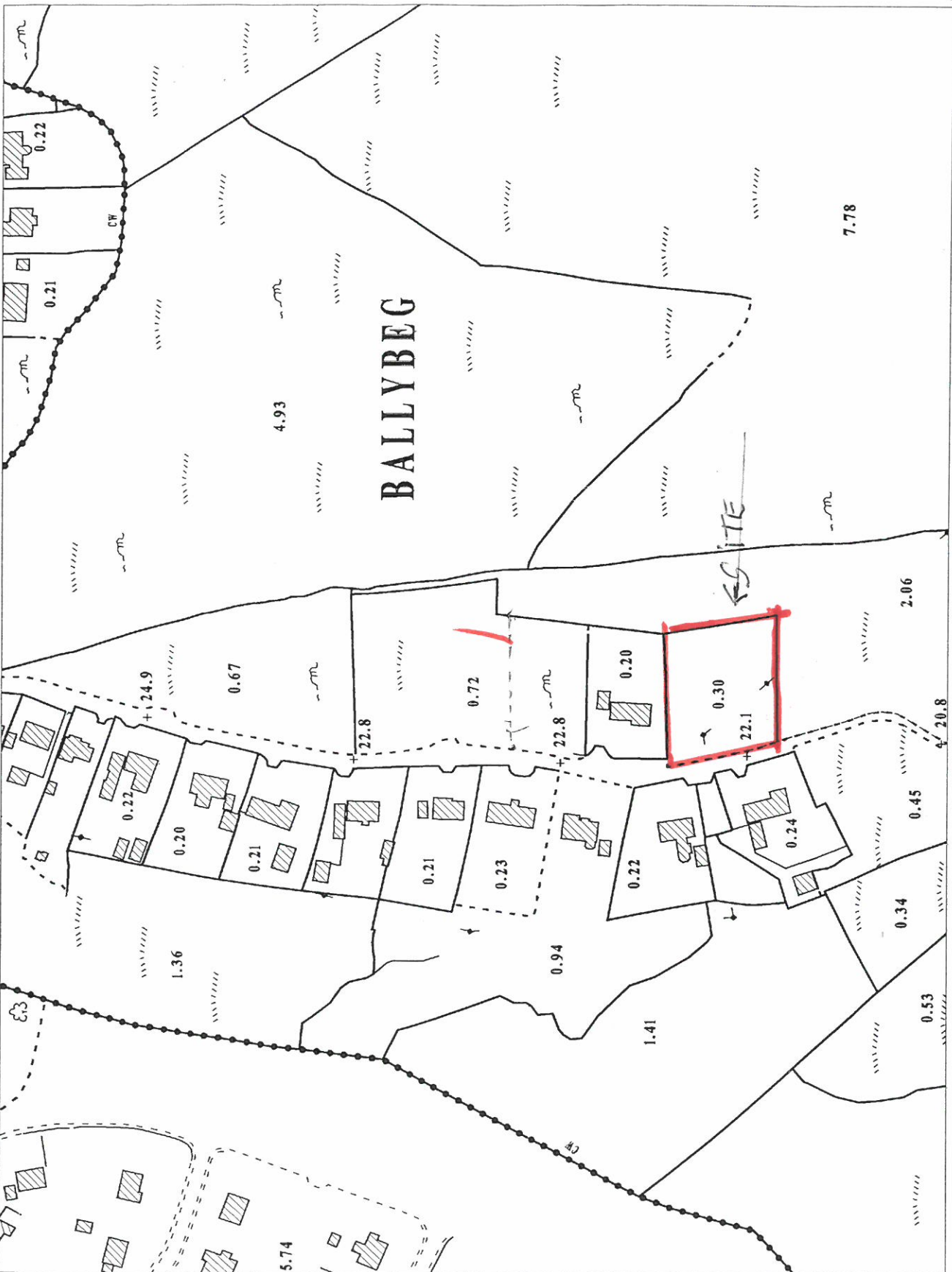

174522
133523

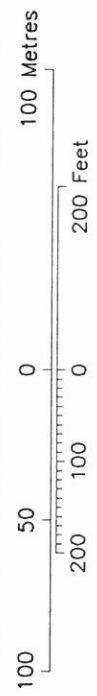

Scale: - 1:2500
Scála: - 1:2500

Plot Ref. No. 19644_1_3
Plot Date 08-OCT-2004

DESCRIPTION

MAP SCALES

1:2500
4380-A



Printed by Mid-West Maps, 94A Henry Street, Limerick City.
Searlóinn sáirgígeadh neamhdharaíne cóigeart: Shuirbhíreacht Ordnála Éireann agus Rialtas na hÉireann.
Unauthorised reproduction infringes Ordnance Survey Ireland and Government of Ireland copyright.
Gach ceist ar cásánach. Ní ceadmhach aon chuid den fhóilsceall seo, ach nó aon chuid de a tharchar in aon fhoirm ná ar aon bhealach eile a scríobhinn nómh ré ó úinéir an eabóid. All rights reserved. No part of this publication may be copied, reproduced or transmitted in any form or by any means without the prior written permission of the copyright owners.

© Suirbhíreacht Ordánála Éireann, 2003
© Ordnance Survey Ireland, 2003

