

**From:** Jennifer Collins  
**Sent:** Monday 28 February 2022 10:57  
**To:** Annette Ryan  
**Subject:** FW: Emailing Folio Map [REDACTED]  
**Attachments:** Folio Map [REDACTED]

Jennifer Collins  
A/Executive Planner  
Forward Planning  
Planning Department  
Economic Development Directorate  
Clare County Council, Áras Contae an Chláir, New Road, Ennis, Co. Clare, V95 DXP2  
T: 065 6846452 | E: [jcollins@clarecoco.ie](mailto:collins@clarecoco.ie) | W: [www.clarecoco.ie](http://www.clarecoco.ie)



COMHAIRLE CONTAE AN CHLÁIR  
CLARE COUNTY COUNCIL



**From:** Dermot O'Brien <[REDACTED]>  
**Sent:** Monday 28 February 2022 10:27  
**To:** Jennifer Collins <[JCollins@clarecoco.ie](mailto:JCollins@clarecoco.ie)>  
**Subject:** Emailing Folio Map [REDACTED]

Hi Jennifer I would like to add the town land name of Bunratty to my application for AG3 to be made residential portfolio [REDACTED]. You refer no S2-049. please note I received no confirmation letter of my submission I have attached also the map for the aforementioned field kind regards Dermot O'Brien

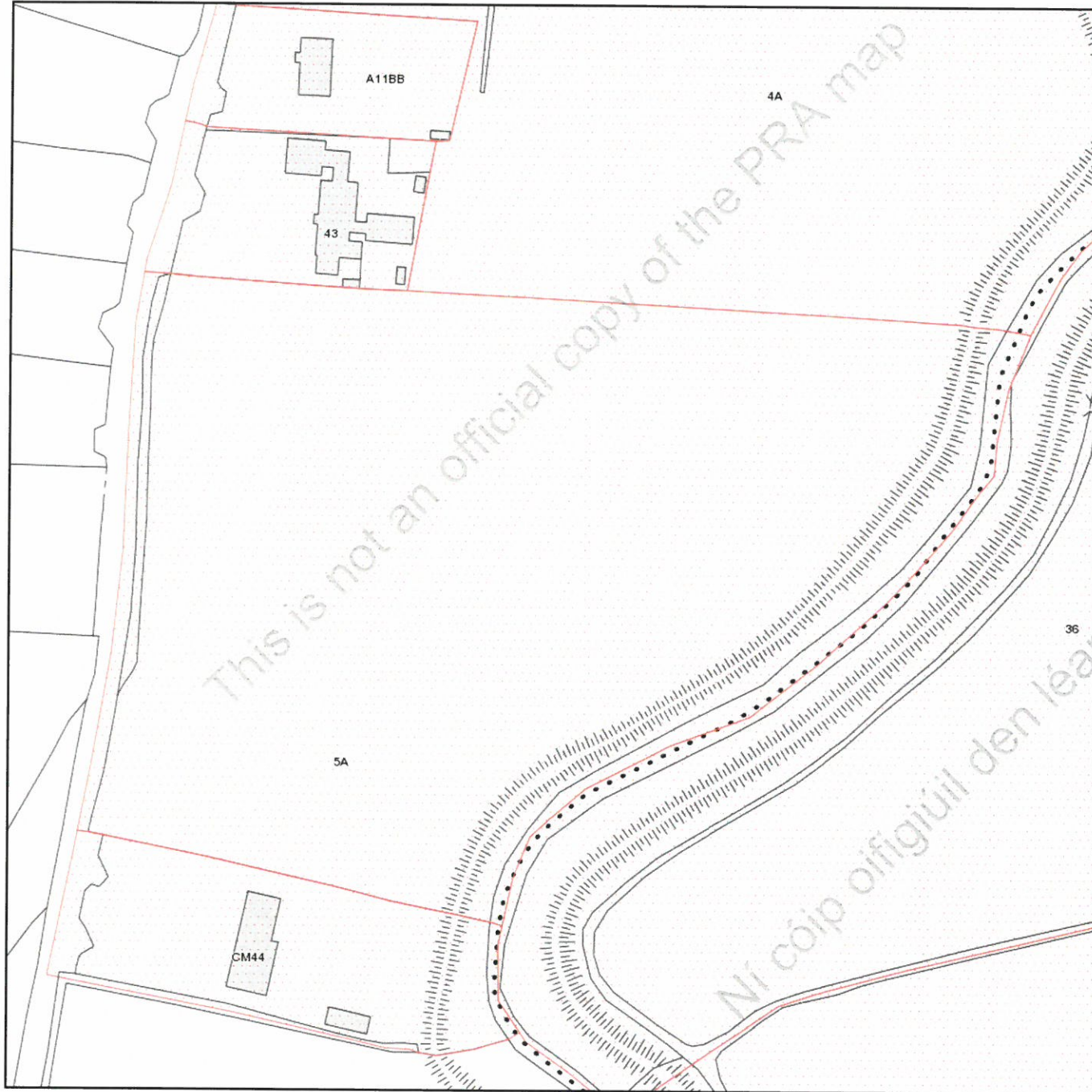

The Property  
Registration Authority  
An tÚdarás  
Clárúcháin Maoine



Print map images taken from [www.landdirect.ie](http://www.landdirect.ie) may be used for information purposes only.

Ní fhéadtar na hiomhánna léarscáile priontáilte arna fháil ó [www.landdirect.ie](http://www.landdirect.ie) a úsáid ach chun críocha eolais amháin.

This map incorporates Ordnance Survey Ireland (OSi) mapping data under a licence from OSi.  
Copyright © OSi and Government of Ireland.

Corraíonn an mapa seo sonraí mapála Shuirbhéireacht Ordanáis na hÉireann (OSi) faoi cheadúnas ón OSi.  
Cóipcheart © OSi agus Rialtas na hÉireann

**The registry operates a non-conclusive boundary system.**

**The Registry Map identifies properties not boundaries meaning neither the description of land in a register nor its identification by reference to a registry map is conclusive as to the boundaries or extent.** (See Section 85 of the Registration of Title Act, 1964). As inserted by Section 62 of the Registration of Deed and Title Act 2006.

**Feidhmíonn Clárúcháin na Talún córas teorann neamhdhochtloite. Aithníonn Mapa na Clárúcháin maoine, nach ionann agus teorainneacha, rud a chiallaíonn nach bhfuil an cur síos ar thalamh i gclár ná a haithint trí thagairt do mhapa clárúcháin cinntitheach maidir le teorainneacha ná fairsinge.** (Féach Alt 85 den Acht um Chlárú Teidil, 1964). Mar a ionadaíodh ag Alt 62 den Acht um Chlárú Gníomhas agus Teidil 2006.

Creation Date: Wednesday, August 26, 2015 2:52:58 PM

