

GILLEECE McDONNELL O'SHAUGHNESSY LTD

■ CYPRUS HOUSE, CYPRUS AVE, DOORADOYLE RD., CO. LIMERICK. Telephone: (061) 500050
Post Code: V94 C2W4 E-Mail: info@gmcdos.ie VAT Registration No: IE 6375106N



G:M:D:S
ARCHITECTURAL
CONSULTANTS
&
CHARTERED
SURVEYORS

Mr Helen Quinn, Senior Planner
Liam Conneally, Director of Economic Development, Shannon Municipal District,
Clare County Council,
Planning Department,
New Road,
Ennis,
Co Clare.

Date: 10th March 2022

Re: **Submission – Clare County Development Plan 2022 2028**

Lands at Moneennagliggin South, Meelick, Co Clare.

Applicant: Ms Therese Hunt.

Dear Sir/ Madam

We have been requested by our client Ms Therese Hunt to submit a parcel of land at Moneennagliggin South for consideration at part of the review of the Clare County Council Development Plan 2017-2023.

Ms Hunt is the full owner of the land. We attach O.S.Map with land outlined in red (circa 1.43 Ha).

The applicant requests that this parcel of land at Moneennagliggin South could be considered for rezoning as part of the Clare County Council Development Plan 2022 2028 from existing zoning of agricultural land to residential one off housing development land to extend the existing on off housing cluster.

Should you require any further information please contact the undersigned.

Yours sincerely

JOSEPH O'SHAUGHNESSY
MRICS MSCSI MASI



Land Registry Compliant Map

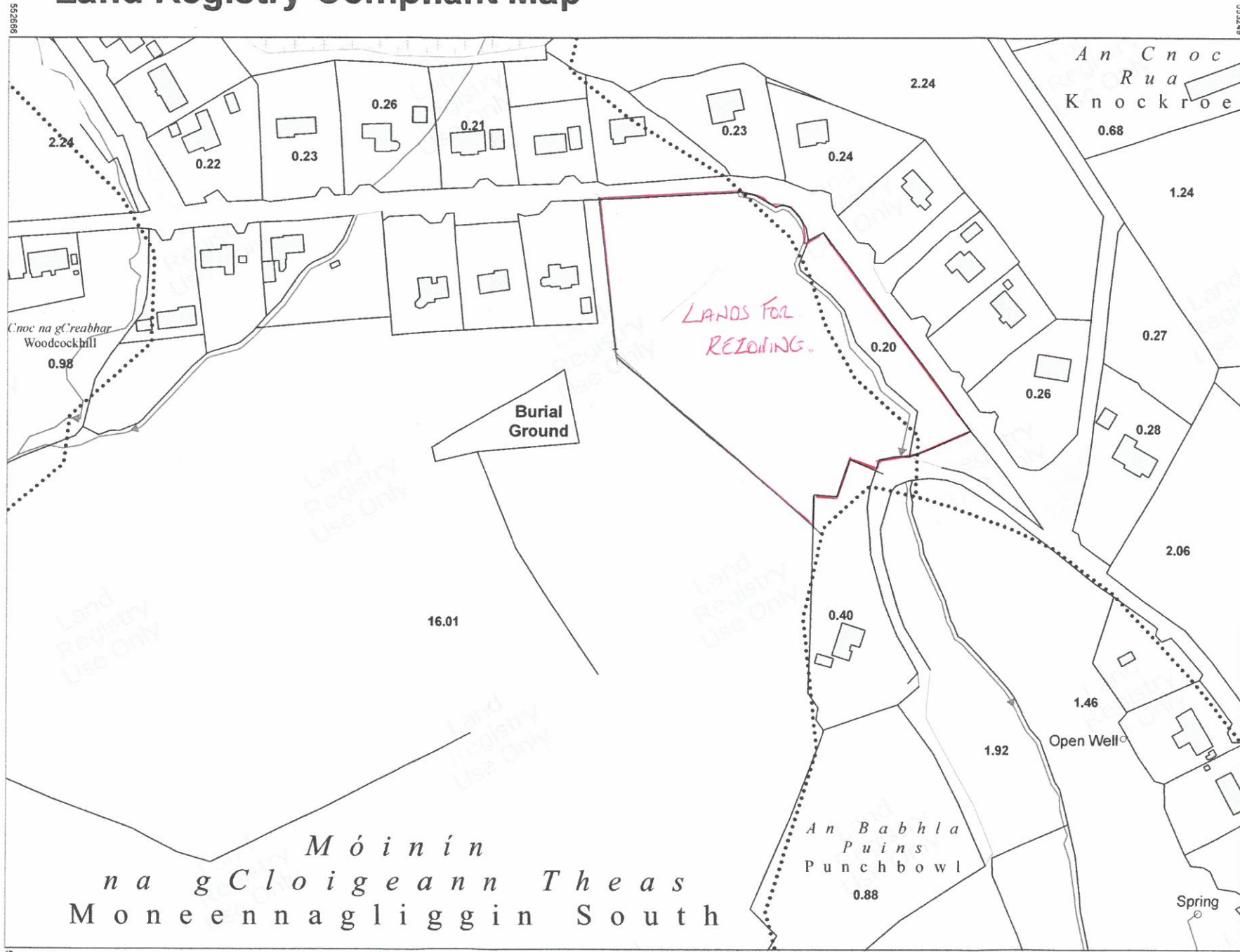

CENTRE COORDINATES:
ITM 552958,661184

PUBLISHED: 17/06/2021
ORDER NC: 50200832

MAP SERIES: 1:2,500
MAP SHEET: 4621-C

COMPILED AND PUBLISHED:
Ordnance Survey Ireland,
Phoenix Park,
Dublin 8,
Ireland.

Unauthorised reproduction
infringes Ordnance Survey Ireland
and Government of Ireland
copyright.

All rights reserved.
No part of this publication may
be copied, reproduced
or transmitted in any form
or by any means without the
written permission of
the copyright owners.

The representation on this map
of a road, track or footpath
is not evidence of the existence
of a right of way.

Ordnance Survey maps
never show legal property
boundaries, nor do they
show ownership of
physical features.

© Suirbhéireacht Ordanáis Éir
2021
© Ordnance Survey Ireland, 2021
www.osi.ie/copyright

LEGEND:

<http://www.osi.ie>;
search 'Large Scale Legend'

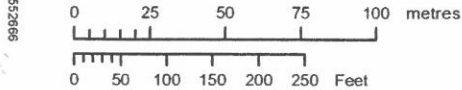

OUTPUT SCALE: 1:2,500

CAPTURE RESOLUTION:
The map objects are only accurate to the
resolution at which they were captured.
Output scale is not indicative of data capture scale.
Further information is available at:
<http://www.osi.ie>; search 'Capture Resolution'

