



Clare County
Development Plan
2023-2029

Draft Clare CDP 2023-2029 - Public Consultation Portal

Submitted By: Anonymous user

Submitted Time: March 23, 2022 3:49 PM

Name

Charles Campbell

Address

[REDACTED]

Email Address

[REDACTED]

Please confirm your Email Address

[REDACTED]

Volume 1

None of the above

Volume 3(a) Ennis Municipal District Written Statements and Settlement Maps

Volume 3(b) Shannon Municipal District Written Statements and Settlement Maps

Athlunkard

Volume 3(c) Killaloe Municipal District Written Statements and Settlement Maps

Volume 3(d) West Clare Municipal District Written Statements and Settlement Maps

Associated Documents

None of the above

Environmental Reports

None of the above

Your Submission

Opposing residential zoning at R2 location on zoning map located next to the Carraig Midhe Estate. The infrastructure of the surrounding area (roads, water pipes, etc) is not suited for continued development of the area. Resources should be reallocated to ensure adequate provisioning of the existing residential area and not at increasing the number of homes. I strongly disagree with the proposed zoning of the R2 residential area as seen on the provisional zoning map.

Location Map



Upload Files

zoning map.jpg, 0.17MB

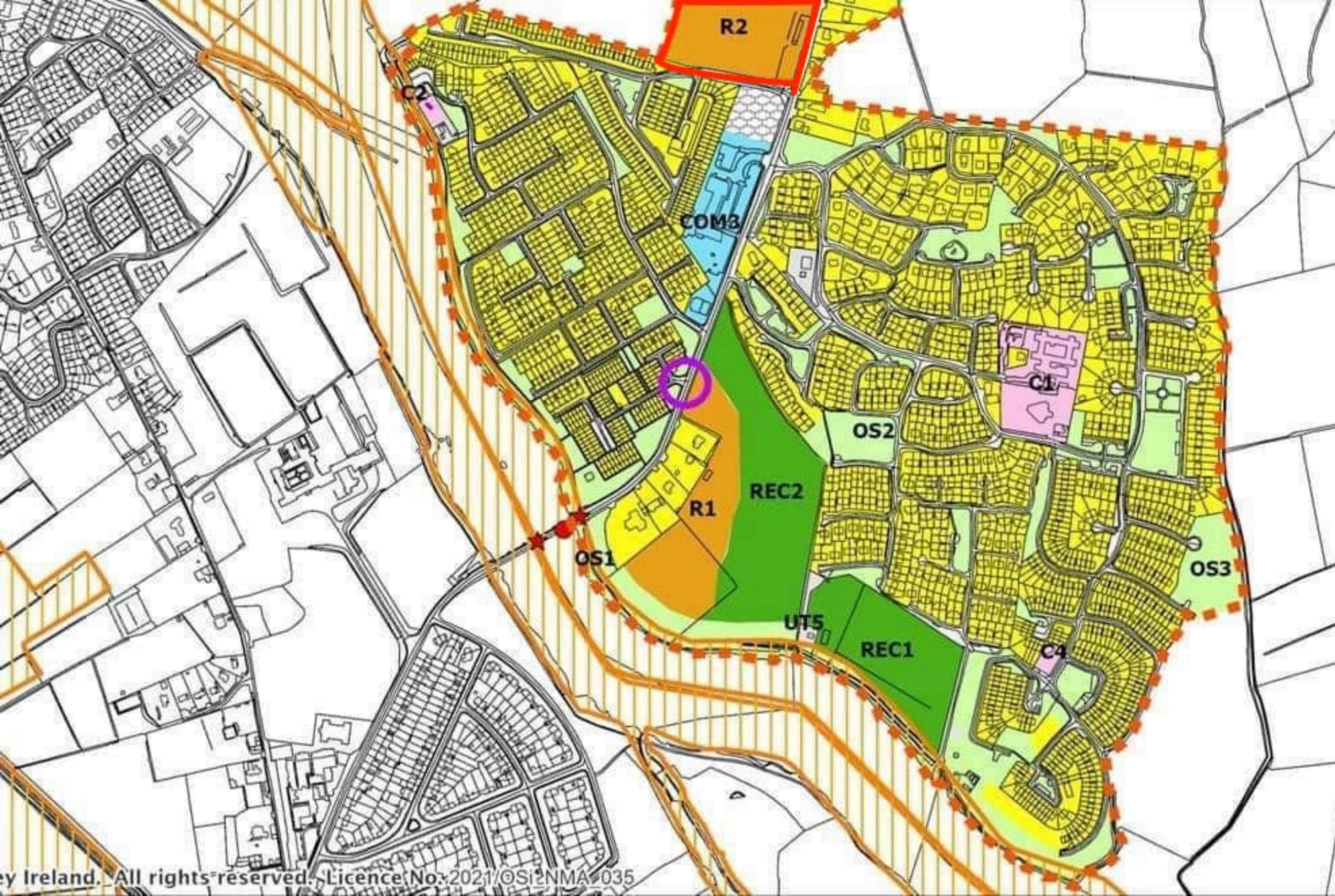

Legend

Settlement Boundary

Built and Natural Heritage

Protected Structure

Recorded Monuments

Special Area of Conservation

Road and Rail Infrastructure

Junction Upgrade

Land Use Zoning

Mixed Use

Commercial

Existing Residential

Residential

Community

Buffer Space

Open Space

Recreation

Utilities