



Clare County  
Development Plan  
**2023-2029**

## **Draft Clare CDP 2023-2029 - Public Consultation Portal**

**Submitted By: Anonymous user**

**Submitted Time: March 23, 2022 8:49 PM**

### **Name**

Joe Whelan Snr & Kevin Whelan

### **Address**

[REDACTED]

### **Email Address**

[REDACTED]

### **Please confirm your Email Address**

[REDACTED]

### **Volume 1**

Core Strategy, Settlement Strategy and Housing

### **Volume 3(a) Ennis Municipal District Written Statements and Settlement Maps**

## **Volume 3(b) Shannon Municipal District Written Statements and Settlement Maps**

## **Volume 3(c) Killaloe Municipal District Written Statements and Settlement Maps**

## **Volume 3(d) West Clare Municipal District Written Statements and Settlement Maps**

Kilrush/Cappa

### **Associated Documents**

None of the above

### **Environmental Reports**

None of the above

### **Your Submission**

The site outlined in red on Map 1 (draft plan 2023-2029), Map 2 (current plan 2017-2023) and the satellite map attached is zoned as COM2 and LDR4 in the current county development plan 2017-2023. Since the last plan was drafted part of this site has been the subject of a successful bid for planning permission for a pitch and putt course (CCC planning ref 19380 in 2019). Because of this planning the site zoning has been changed to recreation in the draft plan. In the meantime due to expansion of the site owner's adjacent business, pressure has come on for space and part of the site currently earmarked for the pitch and putt is likely to be needed for expansion of that business in the near future. Therefore the site owner would like the zoning to remain COM2 in the forthcoming plan. Likewise due to the lack of residential properties the site owner would like the remaining area that was zoned as LDR4 in the 2017-2023 plan to remain as LDR zoning. There is still a possibility that

the pitch and putt will proceed but the site owner does not want to preclude any other development on the site due to a change to recreational zoning. This is necessary in order to protect the 46 employees that the site owner currently has. Thank you.

## Location Map



## Upload Files

Map 1 draft 2023.png, 1.72MB

Map 2 2017-2023.png, 0.93MB

Location satellite map.png, 0.44MB

Pitch & putt site 1.png, 0.3MB

Pitch & putt site 2.png, 0.36MB



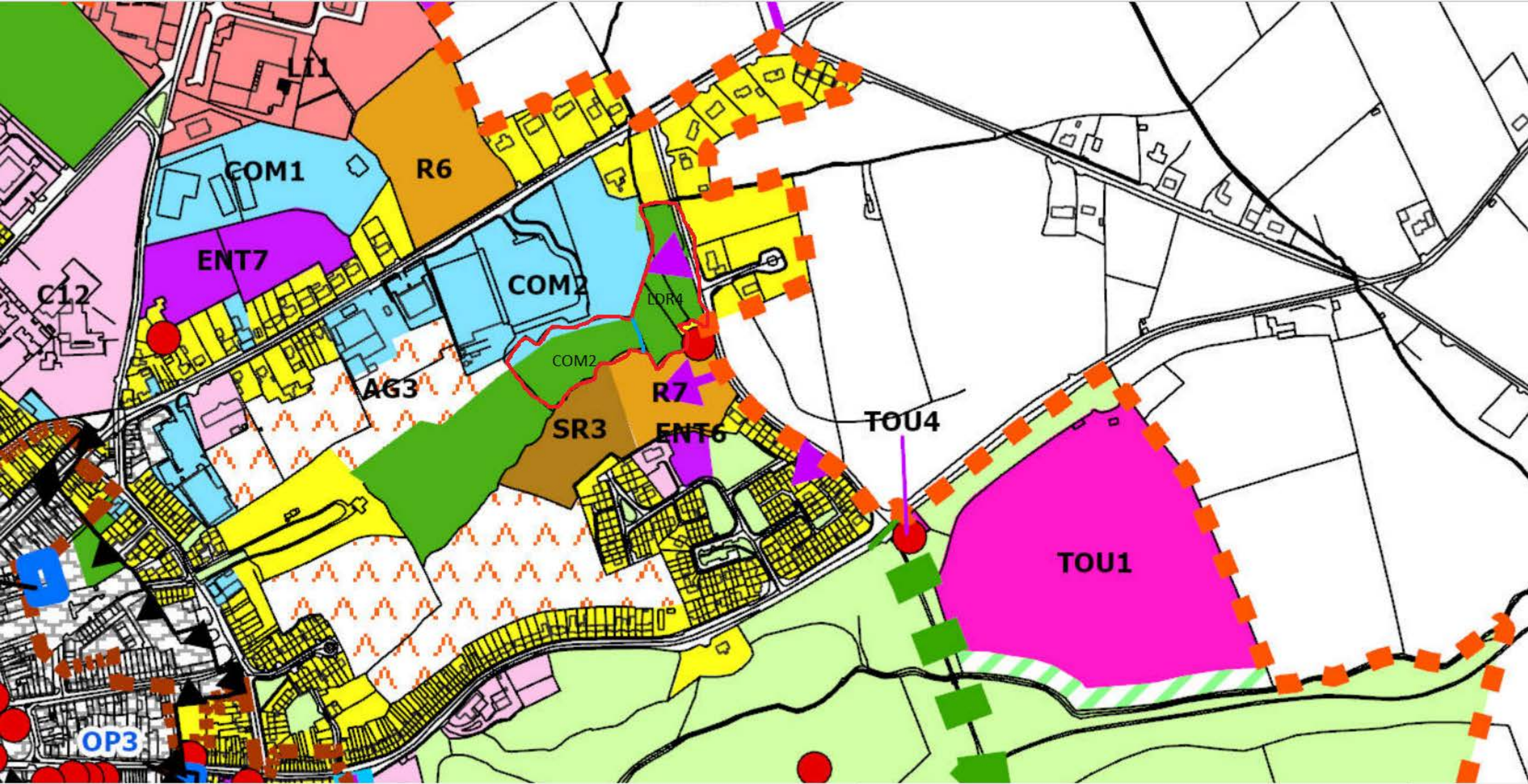



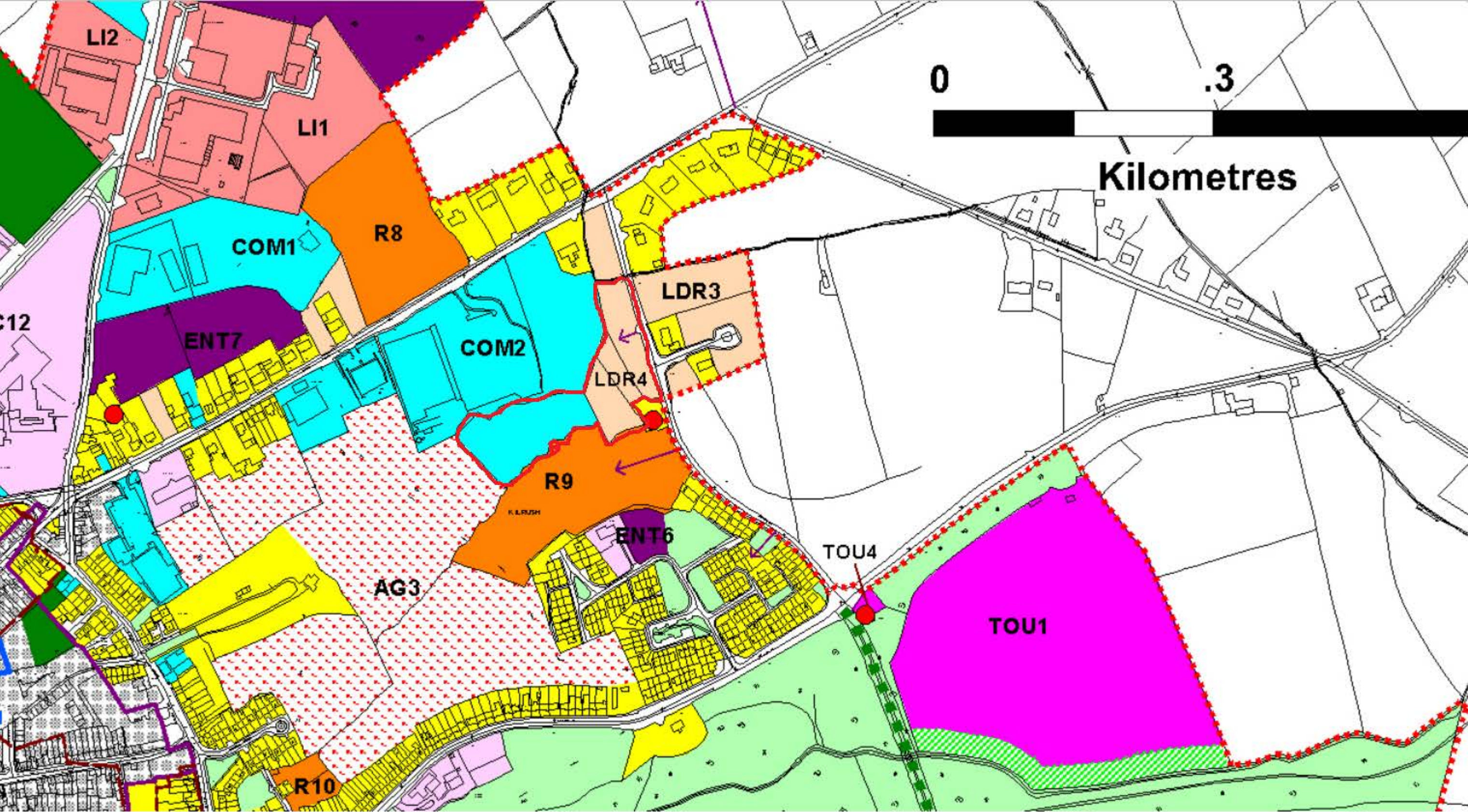



## Location Map

If your submission relates to a specific building or site please identify it on the map below.  
(Please use the drawing tool to draw the boundaries of the building or site on the map. Click or tap on the map to see the drawing tool which is located on the top or bottom right hand corner)

If your submission relates to zoning please also provide an ordinance survey map clearly showing the boundaries of the site outlined in red. (This map can be uploaded via the link below)



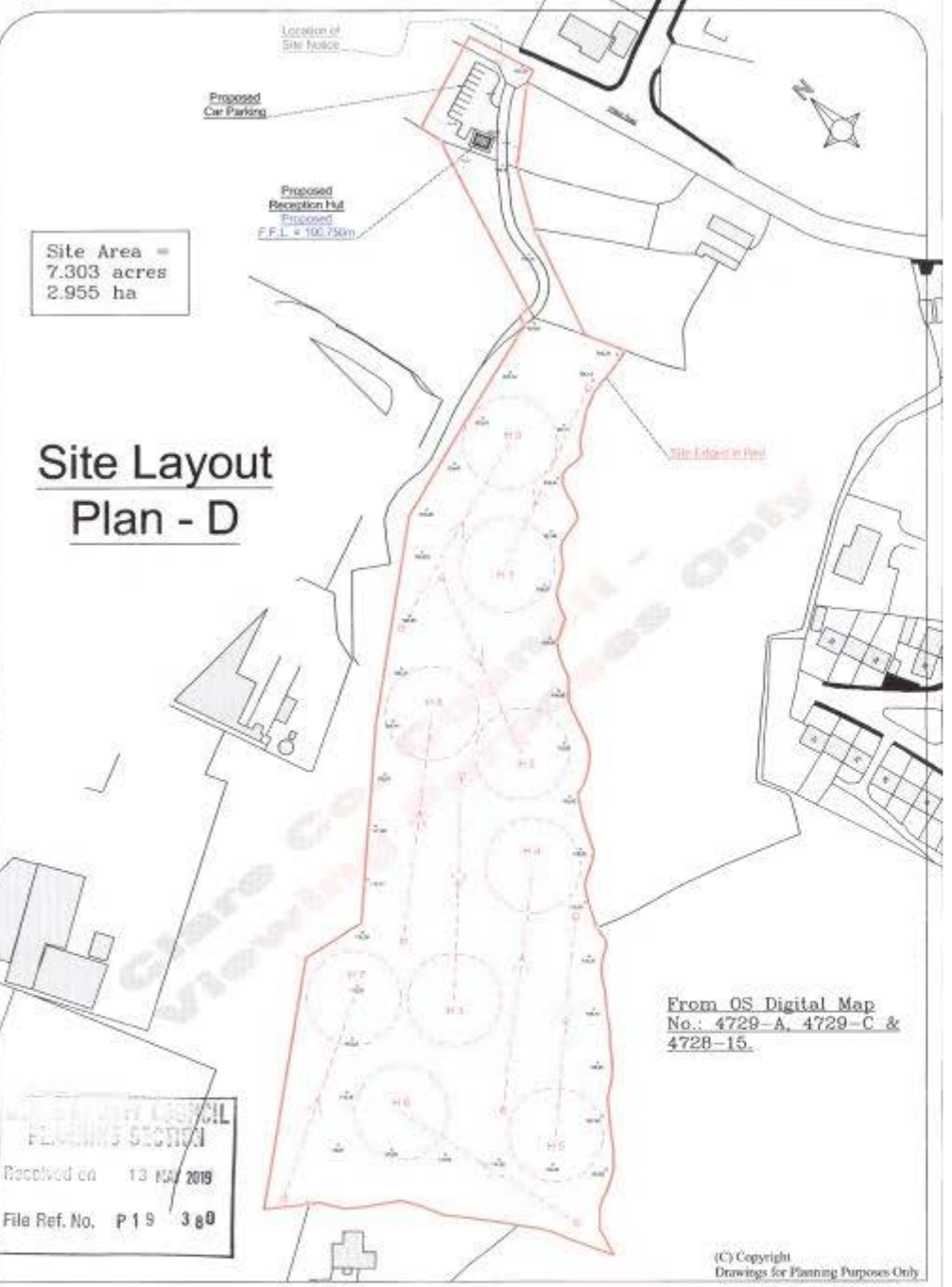

Site Area =  
7.303 acres  
2.955 ha

# Site Layout Plan - D

From OS Digital Map  
No.: 4728-A, 4728-C &  
4728-15.

PLANNING SECTION  
Received on 13 MAY 2019  
File Ref. No. P19 380

(C) Copyright  
Drawings for Planning Purposes Only

PND	Page Title: Proposed Site Layout Plan - D	Project: Proposed Pitch & Put Course	Client: Joe Wilson Ltd., Wilson Road, Kilrush, Co. Clare.	Dwg. No. P/24/19/SL/03	Drawn by: PSD BUILDING CONSULTANCY LTD. Registered Building Surveyors & Quantity Surveyors Kilrush House, Wilson Road, Kilrush, Co. Clare. Tel: 087 654444 Email: psd@psdbuilding.com	Date: 07/05/2019 Scale: 1/1,250
-----	---	--	--	---------------------------	--	------------------------------------

# Planning Pack Map

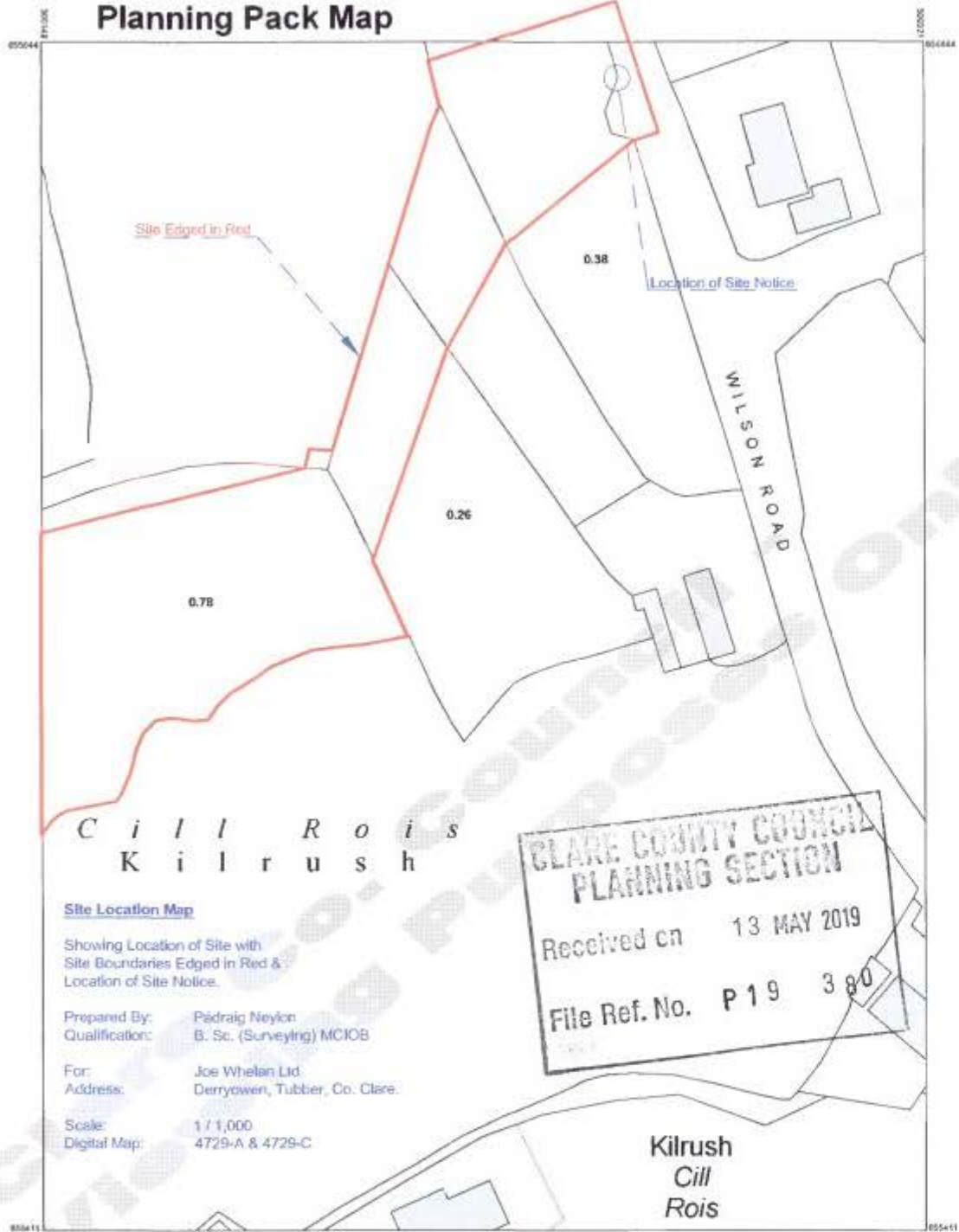

**C i l l R o i s**  
**K i l r u s h**

**Site Location Map**

Showing Location of Site with Site Boundaries Edged in Red & Location of Site Notice.

Prepared By: Pádraig Neylon  
Qualification: B. Sc. (Surveying) MCIOB

For: Joe Whelan Ltd  
Address: Derryowen, Tubber, Co. Clare

Scale: 1 / 1,000  
Digital Map: 4729-A & 4729-C

**CLARE COUNTY COUNCIL  
PLANNING SECTION**  
Received on 13 MAY 2019  
File Ref. No. P19 380

**Kilrush  
Cill  
Rois**

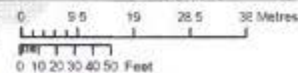

OUTPUT SCALE: 1:1,000



**CENTRE COORDINATES:**  
ITM 500235 655528

**PUBLISHED:** 08/05/2019  
**MAP SERIES:** 1:2,500  
**ORDER NO.:** 50061457\_1  
**MAP SHEETS:** 4729-A, 4729-C

**CAPTURE RESOLUTION:**  
The map objects are only accurate to the resolution at which they were captured. Output scale is not indicative of data capture scale.  
Further information is available at <http://www.osi.ie>, search 'Capture Resolution'.  
**LEGEND:**  
<http://www.osi.ie>, search 'Large Scale Legend'

**COMPILED AND PUBLISHED BY:** Ordnance Survey Ireland, Phoenix Park, Dublin 8, Ireland.  
All rights reserved. No part of this publication may be copied, reproduced or transmitted in any form or by any means without the prior written permission of the copyright owners.

Ordnance Survey maps never show legal property boundaries, nor do they show ownership of physical features.

© Suirbhéireacht Ordánais Éireann, 2019  
© Ordnance Survey Ireland, 2019  
[www.osi.ie](http://www.osi.ie) / [www.osi.ie/copyright](http://www.osi.ie/copyright)

Unauthorised reproduction infringes Ordnance Survey Ireland and Government of Ireland. The representation on this map of a road, track or footpath is not evidence of the existence

