

# Summer Cove Owners' Management Company CLG

Planning Department  
Clare County Council,  
Áras Contae and Chláir  
New Road  
Ennis Co. Clare  
V95 DXP2

25<sup>th</sup> March 2022

## **Re: Clare County Development Plan 2023-2029**

Dear Sir/Madam,

On behalf of Summercove Owners' Management Company CLG, C/O M&C Property, 9 Lower Cecil Street, Limerick, The management company wish to lodge a submission for the application for the change in zoning in the area located in red on the attached map. The area is located at the top of Summercove Estate, Station Road, Lahinch, Co Clare.

The reason the management company wish to lodge a submission is due to the following:

**Inadequate Space:** there is inadequate space for any potential housing in the area marked in Red on the OSI map, the access from this area on to the road would be unsafe.

**Green Area:** The green area separating Summercove from the road would be a massive loss to all the residents in the estate and nearby houses. Should the area be rezoned for residential development a large number of houses in Summercove would be overlooked by any proposed development and would create a privacy issue for those residents.

**Sewage System:** The sewage system in Lahinch is already under pressure and the management company would query if the facility would be able to sustain any further pressure by adding further houses to the system, especially under the summer season when the area is fully occupied.

**Drainage:** It has been noted that the drainage in the area is in poor condition.

**Traffic Flow:** In the peak of the summer, you will note that motorists encounter a number of problems due to the heavy flow of traffic and cars being parked in undesignated areas. This causes a number of issues for the residents in Summercove, especially with no footpath in situ for residents to walk on.

Should you have any queries please do not hesitate to contact me.

Yours sincerely,

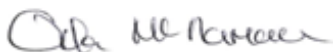

---

Orla McNamara  
M&C Property  
For & on Behalf of Summercove Owners' Management Company CLG

# OSI Place Map

Ordnance Survey Ireland Licence No EN 0053622  
 © Ordnance Survey Ireland Government of Ireland



National Mapping Agency

**CENTRE COORDINATES:**  
 ITM 510131,687781

**PUBLISHED:** 15/03/2022  
**ORDER NO.:** 50256544\_1

**MAP SERIES:** 1:2,500  
**MAP SHEETS:** 4083-C, 4083-D

**COMPILED AND PUBLISHED BY:**  
 Ordnance Survey Ireland,  
 Phoenix Park,  
 Dublin 8,  
 Ireland.

Unauthorised reproduction infringes Ordnance Survey Ireland and Government of Ireland copyright.

All rights reserved.  
 No part of this publication may be copied, reproduced or transmitted in any form or by any means without the prior written permission of the copyright owners.

The representation on this map of a road, track or footpath is not evidence of the existence of a right of way.

Ordnance Survey maps never show legal property boundaries, nor do they show ownership of physical features.

© Suirbhreacht Oranáis Éireann, 2022  
 © Ordnance Survey Ireland, 2022  
[www.osi.ie/copyright](http://www.osi.ie/copyright)

**LEGEND:**  
<http://www.osi.ie>,  
 search 'Large Scale Legend'

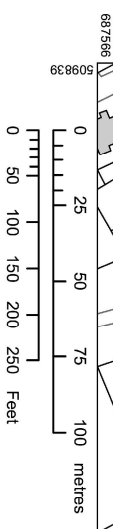
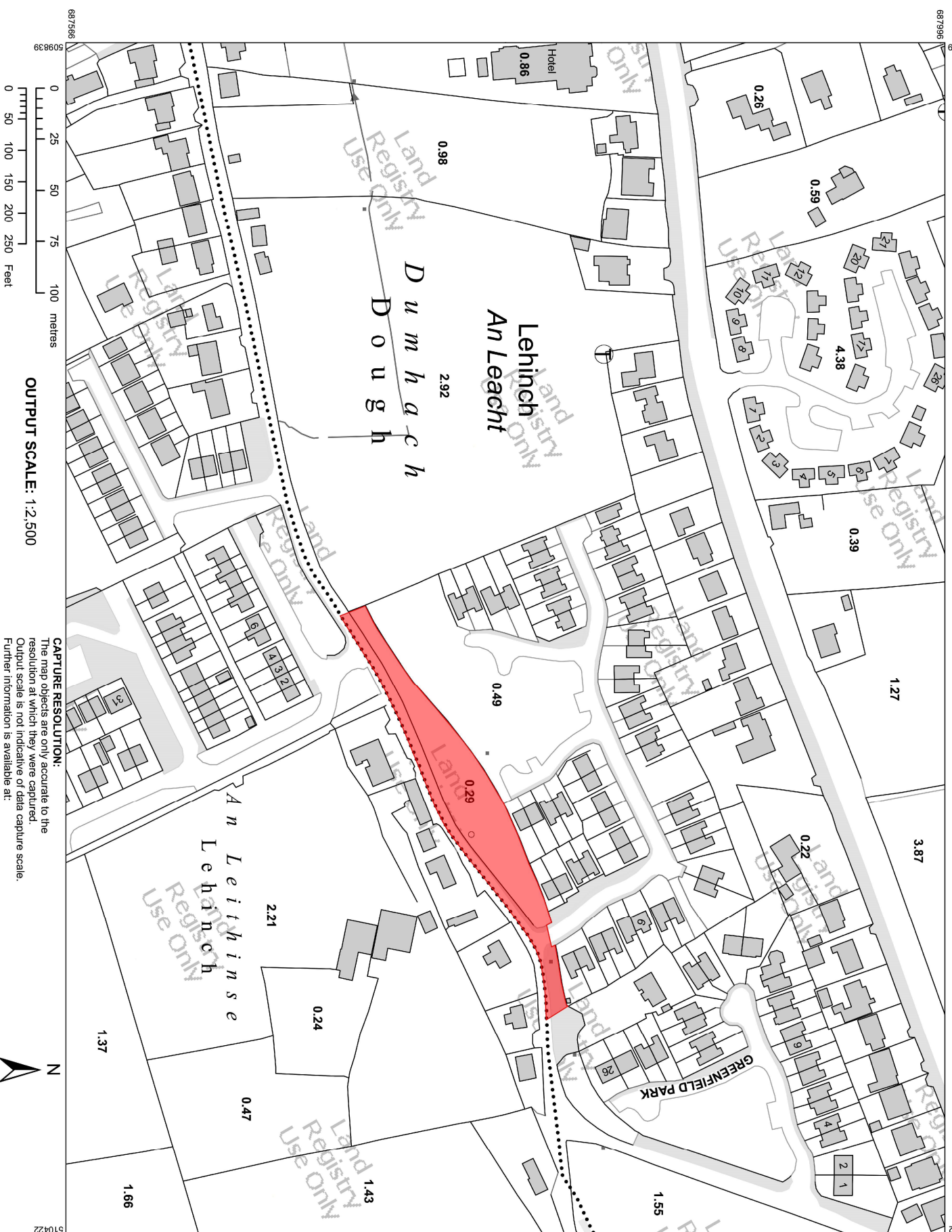

OUTPUT SCALE: 1:2,500

**CAPTURE RESOLUTION:**  
 The map objects are only accurate to the resolution at which they were captured.  
 Output scale is not indicative of data capture scale.  
 Further information is available at:  
<http://www.osi.ie>, search 'Capture Resolution'



687566

687566

687986

687986

509839

510422