

From: [REDACTED]
To: [Development Plan](#)
Subject: Fwd: Request to Clare CoCo to Rezone Site Raheen Rd Tuamgraney Co Clare
Date: Tuesday 7 April 2026 14:33:50
Attachments: [REDACTED]

Dear Madam/Sir

Please see below my request for rezoning of site owned by myself at Raheen Rd Tuamgraney Formerly Mc Mahon Transport site that i sent on 7/12/2025. I have learned in recent days that request has not been successful. At present the site has planning for 2 light Industrial units, i have placed the Property on the market for sale just over 12 months ago with Gohery Properties Galway. We have not had a single solid enquiry that we could pursue to sell this site to.

I am of the opinion that for the site to have any potential it needs to be rezoned to a Residential site. Taking into account the need for housing across the country and also the new Developer Lead Waste Water Treatment initiative that is in Place which would also benefit this site in any further applications to Clare Co Co.

My Request is to Ask Clare Co Co to rethink its vision on this site and to Rezone it to a Residential Zoning.

I had requested a meeting with the Forward planning unit 7/8 weeks ago but haven't had any response to this request.

I would appreciate your support on this and trust you will make the correct decision.

Sincerely Yours

Michael Mc Mahon

[REDACTED]
[REDACTED]
[REDACTED]

Sent from my iPad

Begin forwarded message:

From: [REDACTED]
Date: 7 December 2025 at 16:11:45 GMT
To: [REDACTED]
Subject: Request to Clare CoCo re zoning Ind to RESIDENTIAL Dec 2025

--

Sent with Genius Scan for iOS.
[https://scanner.topsec.com/?](https://scanner.topsec.com/)

[REDACTED]

Sent from my iPad

Killaloe Consultants Ltd. .

Rahenabeg .
Killaloe ,
Co. Clare.

Engineering , Architectural and Project Management Services .
[REDACTED]

The Administrative Officer
Planning Section
Clare County Council
New Road
Ennis
Co. Clare.
4-12-2025

Re NPF Housing Growth – Additional Residential Land

A chara ,

We request in relation to the above that the Land outlined in red on the attached map at Raheen Road , Tuamgraney , Co. Clare be re zoned from existing Commercial to Residential . We are of the opinion that this land is suitable for zoning to residential use and that if re- zoned as suggested this will help to meet the objectives of the NPF Implementation : Housing Growth Requirements Ministerial Guidelines in terms of acceleration of housing delivery over the remaining life of the Clare County Development Plan 2026 to 2029 .

Yours faithfully ,



Michael O'Brien
For and on behalf of Michael McMahon

Planning Pack Map

MICHAEL Mc MAHON RAHEEN ROAD TUAMGRANEY & Cloze

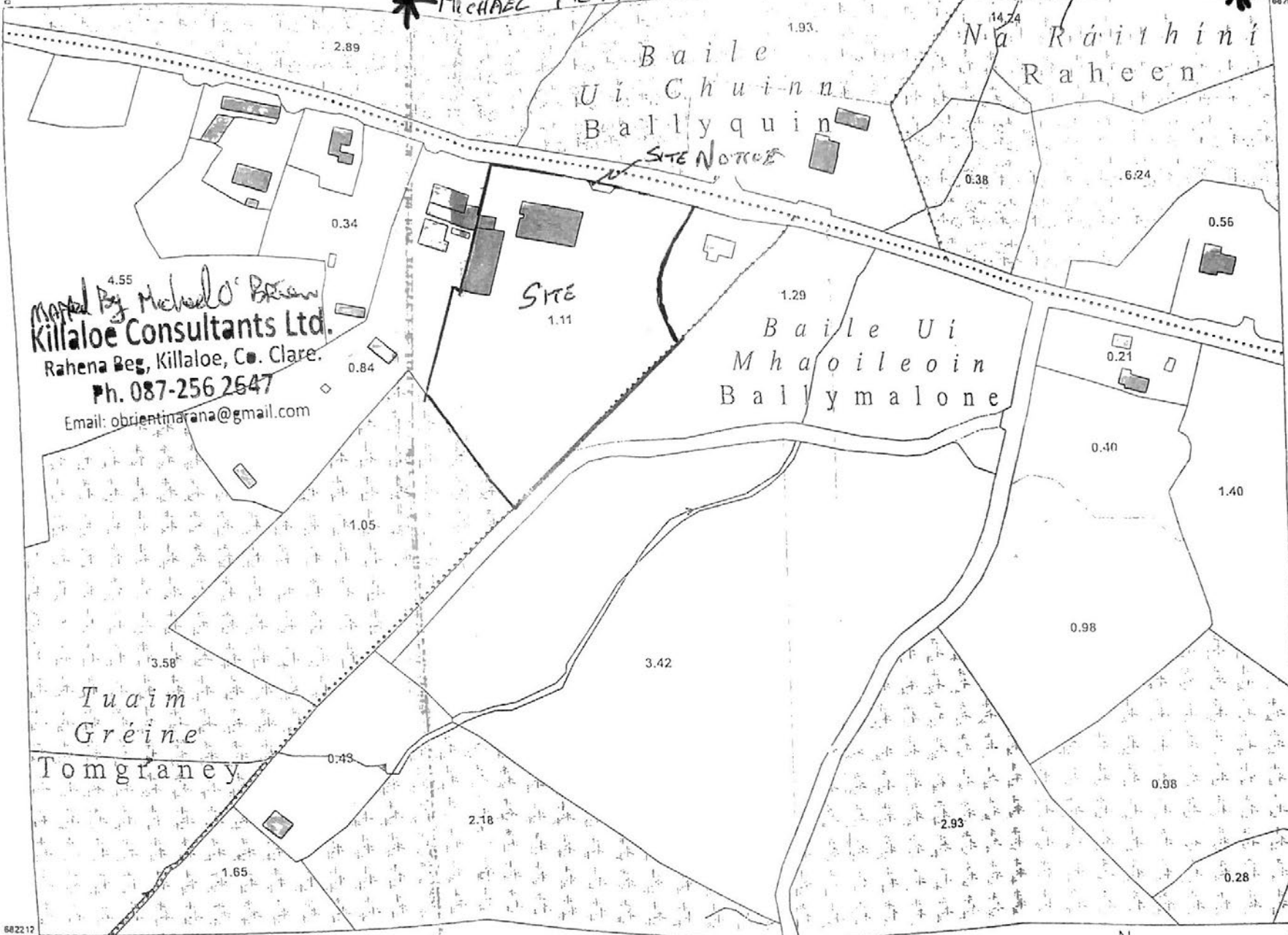

*Map by Michael O'Brien
Killaloe Consultants Ltd.
Rahena Beg, Killaloe, Co. Clare.
Ph. 087-256 2547
Email: obrientimara@gmail.com*

CENTRE COORDINATES:
ITM 564622.682477

PUBLISHED: 11/04/2022
ORDER NO: 50261641

MAP SERIES: 1:5,000
MAP SHEETS: 4214
1:2,500 4214-A

COMPILED AND PUBLISHED BY:
Ordnance Survey Ireland,
Phoenix Park,
Dublin 8,
Ireland.

Unauthorised reproduction
infringes Ordnance Survey Ireland
and Government of Ireland
copyright.

All rights reserved.
No part of this publication may
be copied, reproduced
or transmitted in any form
or by any means without the prior
written permission of
the copyright owners.

The representation on this map
of a road, track or footpath
is not evidence of the existence
of a right of way.

Ordnance Survey maps
never show legal property
boundaries, nor do they
show ownership of
physical features.

© Suirbheireacht Ordánais Éireann,
2022
© Ordnance Survey Ireland, 2022
www.osi.ie/copyright

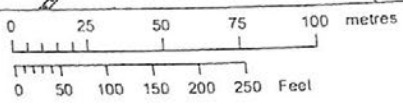

OUTPUT SCALE: 1:2,500

CAPTURE RESOLUTION:
The map objects are only accurate to the
resolution at which they were captured.
Output scale is not indicative of data capture scale
Further information is available at
<http://www.osi.ie> search 'Capture Resolution'



LEGEND:
<http://www.osi.ie>;
search 'Large Scale Legend'